

RESERVOIR ACCESS ROAD/8' STORM/DRAIN LINE
STA. 10+27.38 TO STA. 17+00

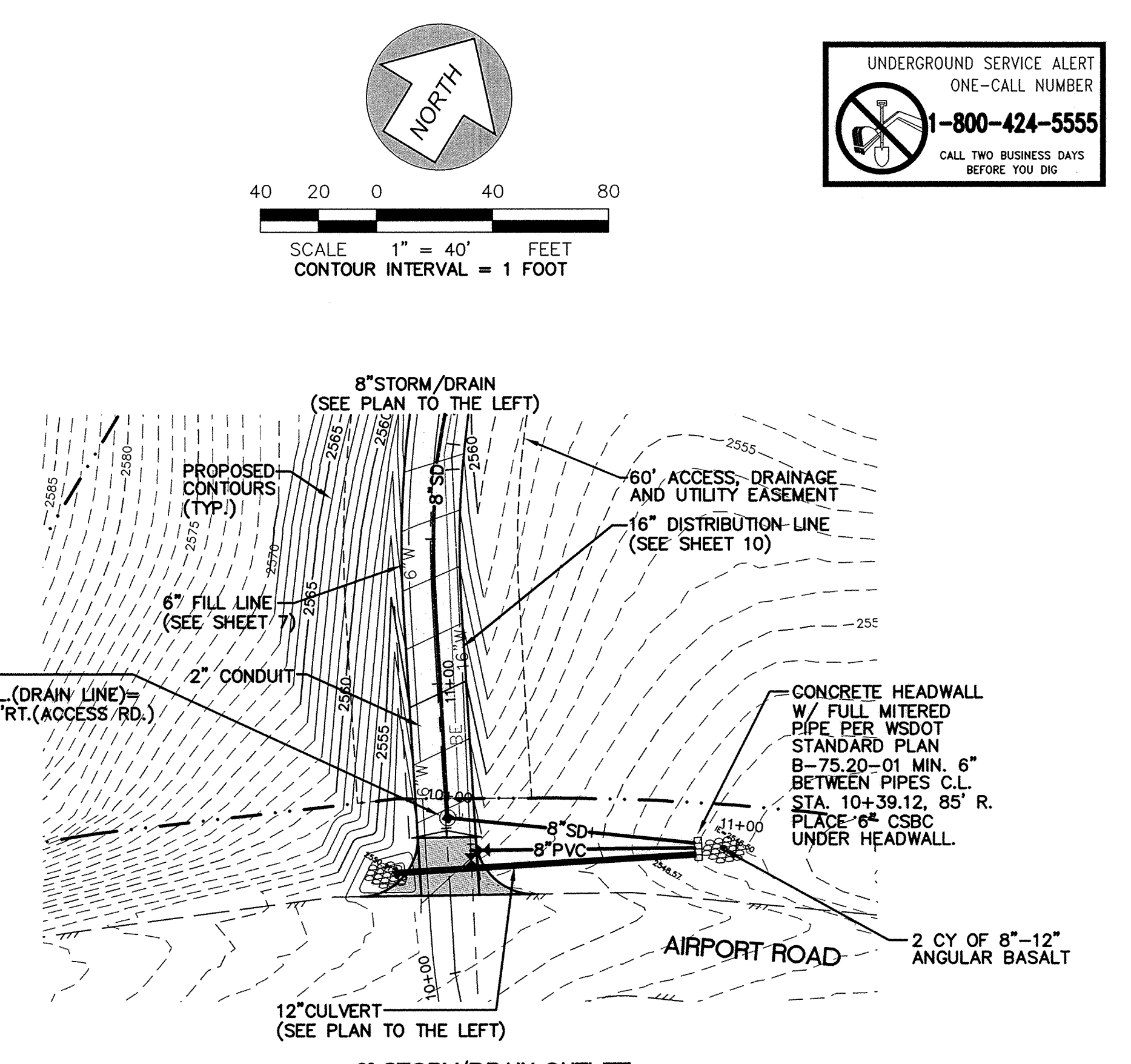

8' STORM/DRAIN OUTLET
STA. 10+00 TO STA. 10+86

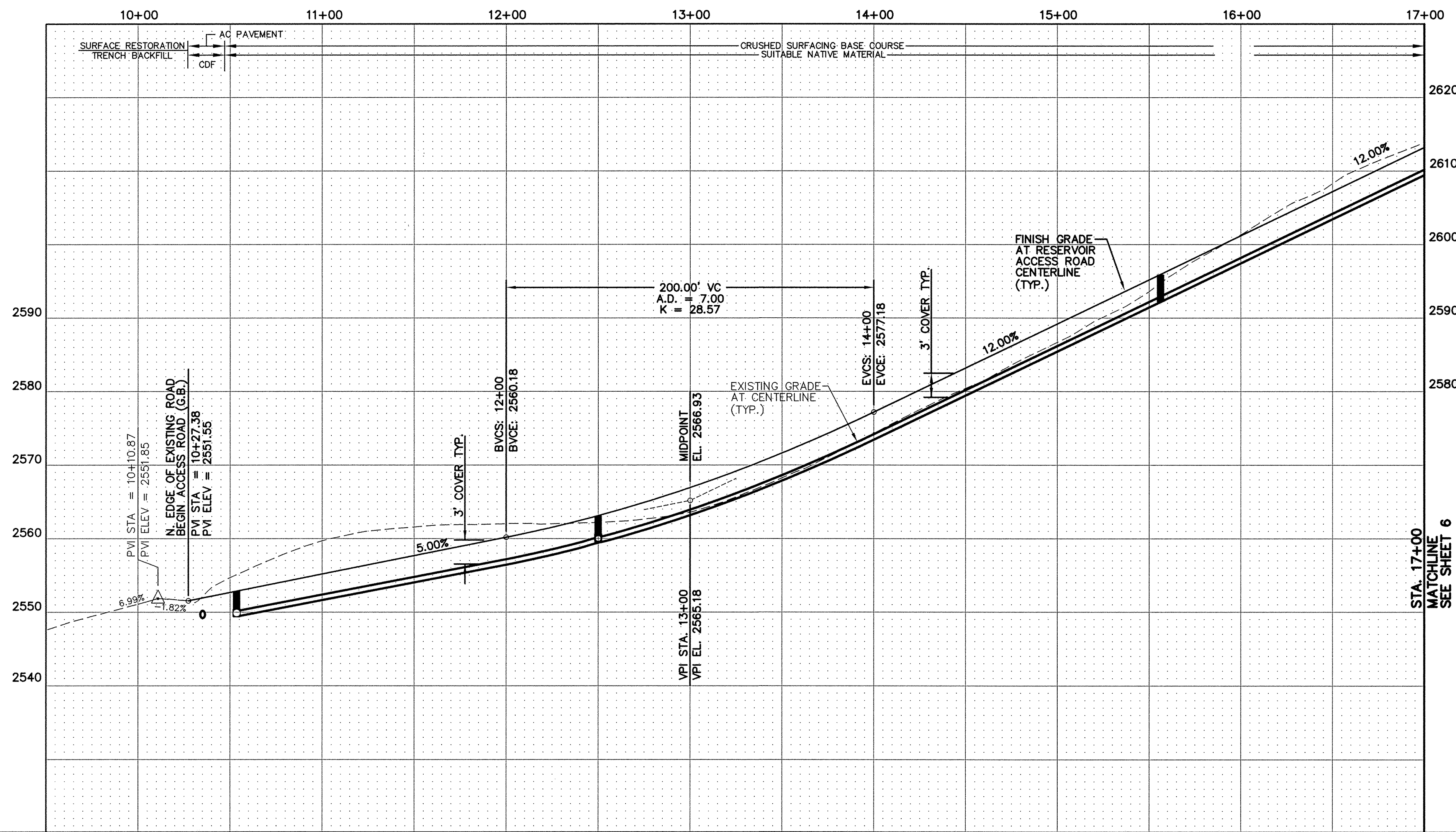

RECORD DRAWING
PER FIELD SURVEY

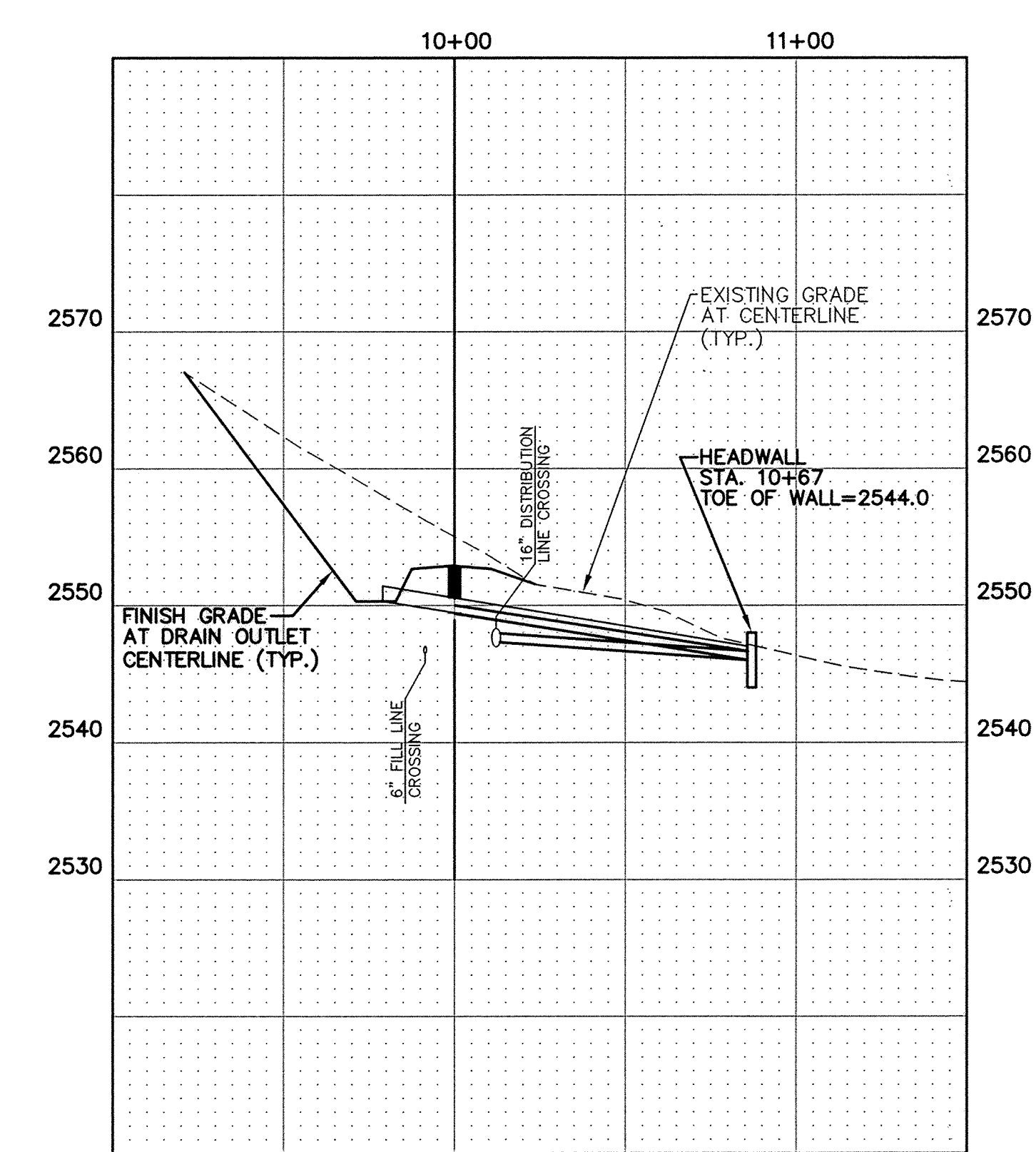

UTILITY STATEMENT

THE UNDERGROUND UTILITIES SHOWN HAVE BEEN LOCATED AS ACCURATELY AS POSSIBLE FROM FIELD SURVEY INFORMATION AND EXISTING DRAWINGS. TAYLOR ENGINEERING, INC. MAKES NO GUARANTEES THAT THE UNDERGROUND UTILITIES SHOWN COMPRISE ALL SUCH UTILITIES IN THE AREA, EITHER IN SERVICE OR ABANDONED. FURTHER, WE DO NOT WARRANT THAT THE UNDERGROUND UTILITIES SHOWN ARE IN EXACT LOCATION INDICATED, ALTHOUGH WE DO CERTIFY THAT THEY ARE LOCATED AS ACCURATELY AS POSSIBLE FROM INFORMATION AVAILABLE.

| No. | Date | By | Ckd. | Appr. | Revisions |
|-----|------|-----|------|-------|-----------------|
| 1 | 2/10 | DWC | | CRG | RECORD DRAWINGS |

| Drawn | Date |
|-------------|-------|
| DJJ | 6/08 |
| Designed | Date |
| BAN,MFM,CRG | 11/08 |
| Checked By | Date |
| RGP | 6/09 |

The Engineer's Seal was removed during the As-Built process. The information of record is as follows:

| Engineer's Name | Exp. No. | Date on plan |
|-----------------|----------|--------------|
| DAVID S. GIBBS | 179639 | 6/20/09 |

Taylor Engineering, Inc.
Civil Design and Land Planning
245 E. Main St.
Pullman, Washington 99163
(509) 334-5115 FAX (509) 334-5956

Approved _____ Date _____

VERTICAL DATUM:
NAVD 83

CITY OF PULLMAN, WASHINGTON

ENGINEERING DIVISION

SCALE
HORIZ. 1"=40'
VERT. 1"=10'

| AIRPORT FIRE FLOW SYSTEM | |
|---|------------------|
| RESERVOIR ACCESS ROAD AND 8' STORM/DRAIN LINE | SHEET 5 22 |
| STA. 10+27 TO STA. 17+00 | |
| 8' STORM/DRAIN OUTLET | |
| STA. 10+00 TO STA. 10+85 | |

UNDERGROUND SERVICE ALERT
ONE-CALL NUMBER
1-800-424-5555
CALL TWO BUSINESS DAYS BEFORE YOU DIG