

SCALE 1" = 40' FEET
 EXISTING CONTOUR INTERVAL = 1 FOOT
 PROPOSED CONTOUR INTERVAL = 1 FOOT

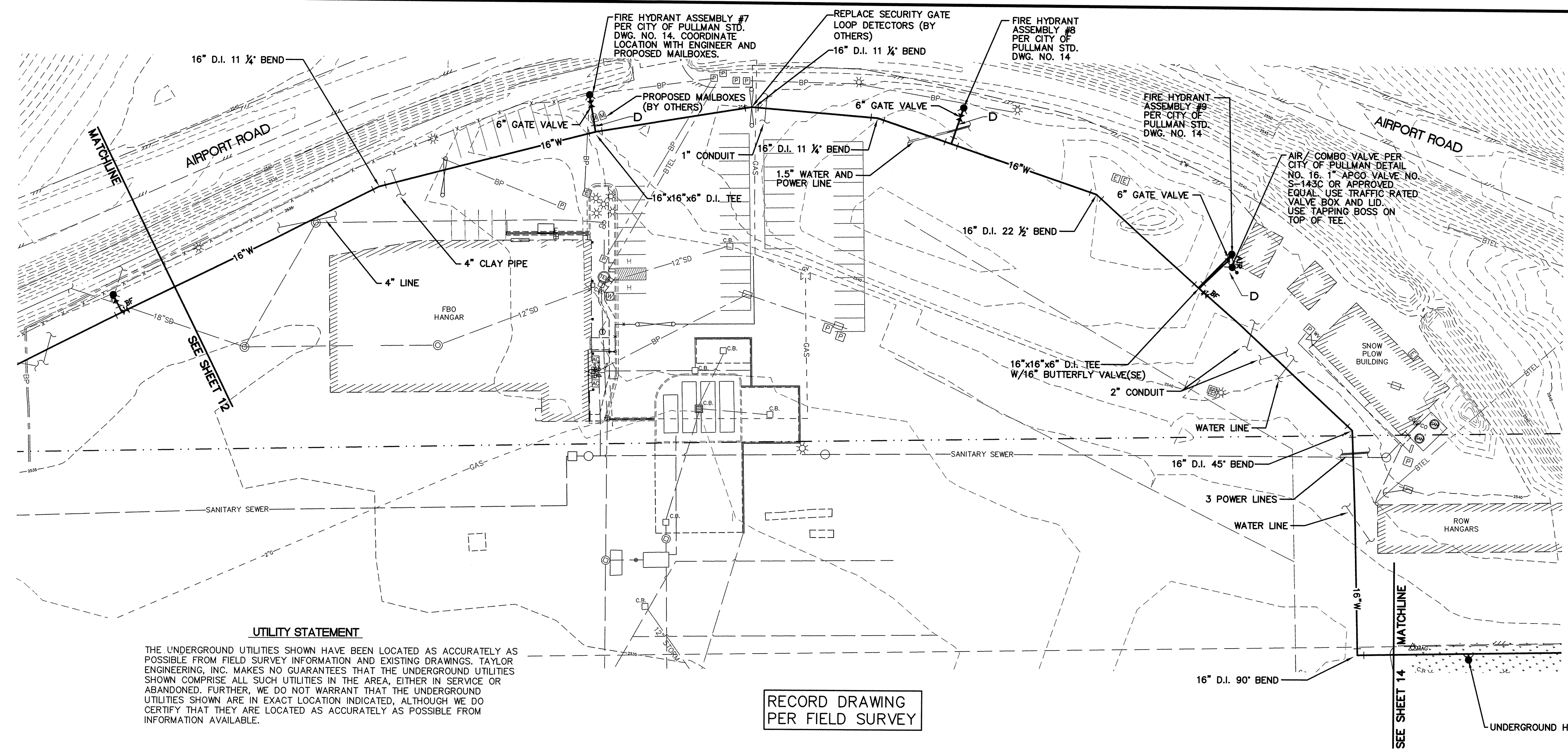

UTILITY STATEMENT
 THE UNDERGROUND UTILITIES SHOWN HAVE BEEN LOCATED AS ACCURATELY AS POSSIBLE FROM FIELD SURVEY INFORMATION AND EXISTING DRAWINGS. TAYLOR ENGINEERING, INC. MAKES NO GUARANTEES THAT THE UNDERGROUND UTILITIES SHOWN COMPRISE ALL SUCH UTILITIES IN THE AREA, EITHER IN SERVICE OR ABANDONED. FURTHER, WE DO NOT WARRANT THAT THE UNDERGROUND UTILITIES SHOWN ARE IN EXACT LOCATION INDICATED, ALTHOUGH WE DO CERTIFY THAT THEY ARE LOCATED AS ACCURATELY AS POSSIBLE FROM INFORMATION AVAILABLE.

**RECORD DRAWING
 PER FIELD SURVEY**

- FINISHED SURFACE NOTES**
- C FINISHED SURFACE PER CITY OF PULLMAN STANDARD DRAWING NO. 21 W/ 3" TOP SOIL
 - D FINISHED SURFACE PER CITY OF PULLMAN STANDARD DRAWING NO. 21 W/ 3" HMA
 - E FINISHED SURFACE PER CITY OF PULLMAN STANDARD DRAWING NO. 21 W/ CDF & 3" HMA

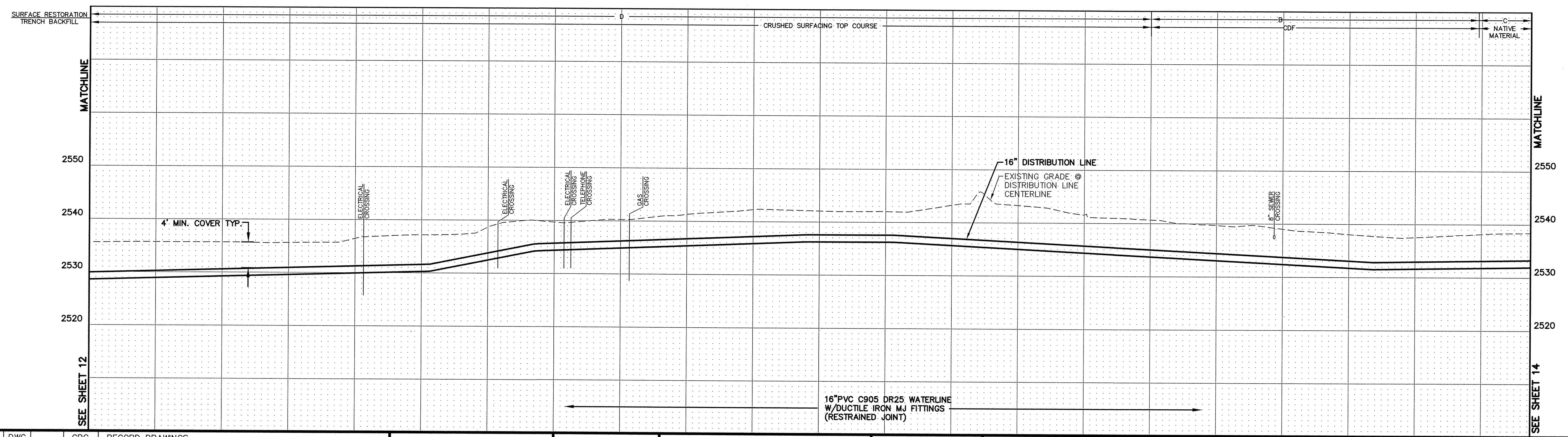

1	2/10	DWC	CRG	RECORD DRAWINGS
No.	Date	By	Ckd.	Appr.
				Revisions

Drawn DJJ **Date** 6/08
Designed CRG **Date** 11/08
Checked By RGP **Date** 6/09

The Engineer's Seal was removed during the As-Built process. The information of record is as follows:
 Engineer's Name: CALVIN S. BORG
 Exp.'s No.: 179639
 Date on job: 11/8/2009

Taylor Engineering, Inc.
 Civil Design and Land Planning
 245 E. Main St.
 Pullman, Washington 99163
 (509) 334-5115 FAX (509) 334-5956

VERTICAL DATUM:
 NAVD 83

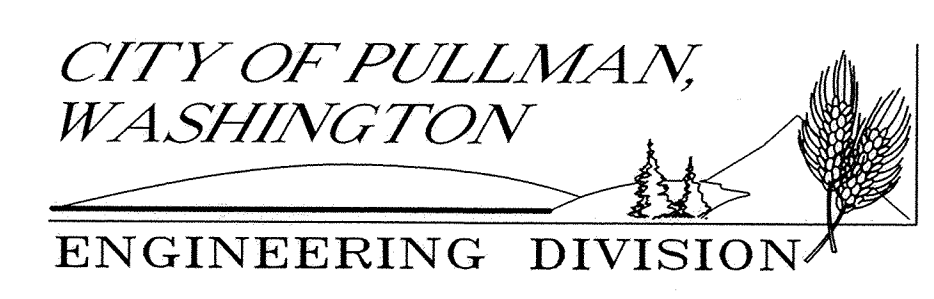

SCALE
 HORIZ. 1"=40'
 VERT. 1"=10'

AIRPORT FIRE FLOW SYSTEM
 16" DISTRIBUTION LINE
 STA. 48+00 TO 58+50

WATER
SHEET
 13
 22